

IQOTR40

3G/HD/SD-SDI Multichannel Fiber Transceiver

Bidirectional conversion of four 3G/HD/SD-SDI signals to/from single-mode fiber optic signals.

The IQOTR40 range from Grass Valley provides bidirectional conversion of four 3G/HD/SD-SDI signals to/from single-mode fiber optic signals. The unit is available in single- or dual-width versions with either HD-BNC or BNC connectors.

Why should you choose this module?

- Suitable for transporting 3G/HD-SDI signals over long distances either within the facility or between sites
- Lower weight and higher density compared with copper cables
- Full GV Orbit compatibility provides an all-inclusive remote configuration, control and monitoring solution
- Comprehensive SNMP support allows easy integration with third-party Network Management Systems

KEY FEATURES

- Multichannel single-mode fiber optic receiver for 3G/HD/SD-SDI signals
- 1310 nm input wavelengths support
- Multichannel single-mode fiber optic transmitter for 3G/HD/SD-SDI signals
- Reclocking for 3 Gb/s, 1.5 Gb/s HD-SDI and 270 Mb/s SDI signals, or asynchronous operation for other frequencies (input range 50 Mb/s to 3 Gb/s)

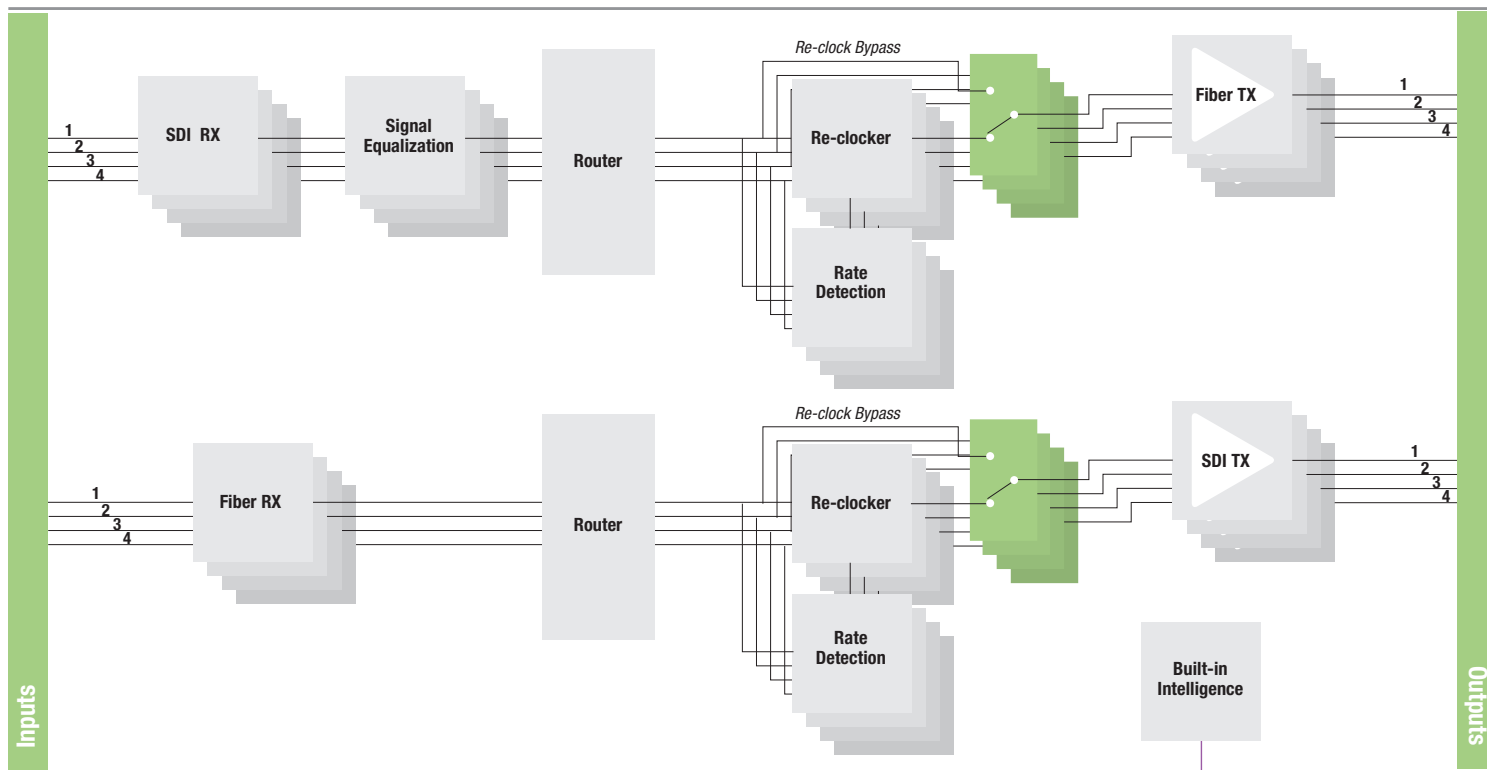

Block Diagram for IQOTR4080-2B3

Network Intelligence, Control & Monitoring

SPECIFICATIONS

Inputs and Outputs

Signal Inputs

SDI inputs: 4x
 Input cable length:
 Up to 80m Belden 1694A @ 3 Gb/s
 Up to 140m Belden 1694A @ 1.5 Gb/s
 Inputs 1-3, up to 350m Belden 1694A @ 270 Mb/s
 Inputs 4-8, up to 160m Belden 1694A @ 270 Mb/s

Signal Outputs

SDI outputs: 4x

Fiber Signal Input

Inputs: Up to 4
 Optical: 3 Gb/s HD-SDI, 1.485 Gb/s HD-SDI or 270 Mb/s SD-SDI
 Connector/format: LC singlemode
 Conforms to:
 SMPTE ST 297-2006
 SMPTE ST 424 (HD level A/B)
 SMPTE ST 292 (HD)
 SMPTE ST 259-C (SD)

Fiber Signal Output

Outputs: 4x
 Optical: 3 Gb/s HD-SDI, 1.485 Gb/s HD-SDI or 270 Mb/s SD-SDI
 Connector/format: LC singlemode
 Conforms to:
 SMPTE ST 297-2006
 SMPTE ST 424 (HD level A/B)
 SMPTE ST 292 (HD)
 SMPTE ST 259-C (SD)

Controls

Indicators

Power: OK (Green)
 CPU: OK (Green flashing)
 Input 1-8: 3G-OK (Blue), HD-OK (Green), SD-OK (Yellow), Bypass (Rate color flashing), Loss (Red)

Video Controls

Input 1 - 8 rate select: 3G, HD, SD, other
 Reclock bypass: On/Off
 Output 1-4 select: Input 1-4
 Output 5-8 select: Input 5-8
 Laser disable (Tx): On/Off/Input Error
 Output mute (Rx): On/Off
 Output mute on I/P error (Rx): On/Off
 Input 1-4 configuration: 1, 2
 Input 5-8 configuration: 1, 2

Configuration rules:
 Primary input OK
 Primary input error
 Secondary input error

Mode use:

Config 1
 Use Config 2
 Use Rules

Delay for rules actions:

OK Timer 0-5s
 Error Timer 0-5s

Input status: Present, Loss, Unknown, Data Rate

Logging:

Input 1-8 Identifier
 Input 1-8 Name
 Input 1-8 Type
 Input 1-8 Data Rate
 Input 1-8 Present
 Input 1-8 Error
 Input 1-8 Loss

Optical logging:

Output 1-8 Tx Laser Bias High Warning
 Output 1-8 Tx Laser Bias Current
 Output 1-8 Tx Power Low Warning
 Output 1-8 Tx Power High Warning
 Output 1-8 Tx Power
 Output 1-8 Tx Wavelength
 Input 1-8 Rx Power High Warning
 Input 1-8 Rx Power Low Warning
 Input 1-8 Rx Power Measurement
 Input/Output 1-8 SFP State

RollTrack controls: On/Off, Index, Source, Address, Command, Status, Sending

RollTrack sources:

Unused
 Input 1-8 Present
 Input 1-8 Rate Unknown
 Input 1-8 Error
 Input 1-8 Loss
 Input 1-8 3G
 Input 1-8 HD
 Input 1-8 SD
 Output 1-8 Tx Laser Bias High/Low Warning
 Input 1-8 Rx Power High Warning
 Input 1-8 Rx Power Low Warning

SPECIFICATIONS

Other Controls

User memories: Name, save and recall 16 user memories

General Specifications

Electrical:

- 3 Gb/s SDI, SMPTE ST 424
- 1.5 Gb/s HD-SDI, SMPTE ST 292
- 270 Mb/s SDI, SMPTE ST 259-C / DVB-ASI

Connector/format: BNC/75Ω panel jack on standard Grass Valley connector panel

Return loss:

- > -15 dB (270 Mb/s, 1.5 Gb/s)
- > -10 dB (3 Gb/s)

Output jitter:

- SD-SDI 0.2 UI (10 Hz) / 0.2 UI (1 kHz)
- 3G/HD-SDI 1.0 UI (10 Hz) / 0.2 UI (100 kHz)

Optical Rx

- Input wavelength range: Min. 1260 nm, Max. 1620 nm
- Input sensitivity: -21 dBm
- Optical power input range: > -0 dBm, < -20 dBm
- Optical return loss: -27 dB
- Link distance:
 - Up to 30 km @ 270 Mb/s
 - Up to 21 km @ 1.5 Gb/s
 - Up to 10 km @ 3 Gb/s

Optical Tx

- Wavelength: 1310 nm
- Spectral width (FWHM): >1.5 nm (typ)
- Output power: 0 to -5 dBm typical (-2 dBm typical)
- Rise and fall time:
 - 135 ps @ 3 Gb/s
 - 270 ps @ 1.5 Gb/s
 - 1.5 ns @ 270 Mb/s
- Extinction ratio: >7.5:1 (typ)
- Link distance:
 - Up to 30 km @ 270 Mb/s
 - Up to 21 km @ 1.5 Gb/s
 - Up to 10 km @ 3 Gb/s

Power Consumption

Module power consumption: 8 PR (B Frames)

ORDERING

IQOTR4079-1B3

3G/HD/SD-SDI multichannel fiber transceiver. 4x HD-BNC 3G/HD/SD-SDI inputs to 4x 1310 nm optical outputs and 4x optical inputs to 4x HD-BNC 3G/HD/SD-SDI outputs.

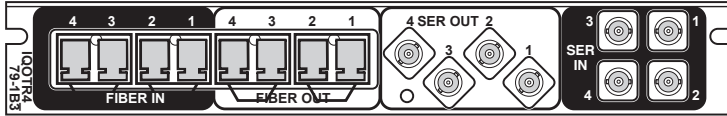

IQOTR4080-2B3

3G/HD/SD-SDI multichannel fiber transceiver. 4x BNC 3G/HD/SD-SDI inputs to 4x 1310 nm optical outputs and 4x optical inputs to 4x BNC 3G/HD/SD-SDI outputs.

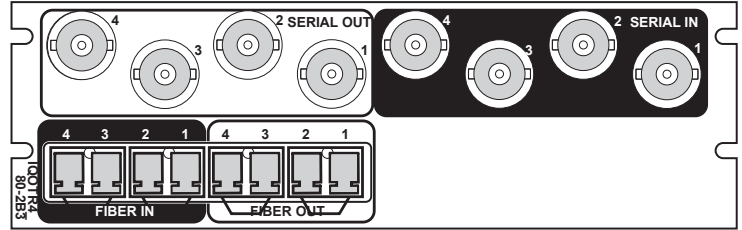

For more details on enclosure types please refer to the IQ Modular Enclosures datasheet.



WWW.GRASSVALLEY.COM

Join the Conversation at **GrassValleyLive** on Facebook, Twitter, YouTube and **Grass Valley** on LinkedIn.



www.grassvalley.com/blog

This product may be protected by one or more patents. For further information, please visit: www.grassvalley.com/patents.

Grass Valley®, GV® and the Grass Valley logo are trademarks or registered trademarks of Grass Valley USA, LLC, or its affiliated companies in the United States and other jurisdictions. Grass Valley products listed above are trademarks or registered trademarks of Grass Valley USA, LLC or its affiliated companies, and other parties may also have trademark rights in other terms used herein.

Copyright © 2019-2021 Grass Valley Canada. All rights reserved. Specifications subject to change without notice.